

Splitboard Crampons

Assembly and Use Instructions

Assembly:

1. Attach Crampon Clip to Small or Large position
2. Adjust to about 1/16" from heelstay
3. Tighten screw with M5 Allen Key and crescent wrench

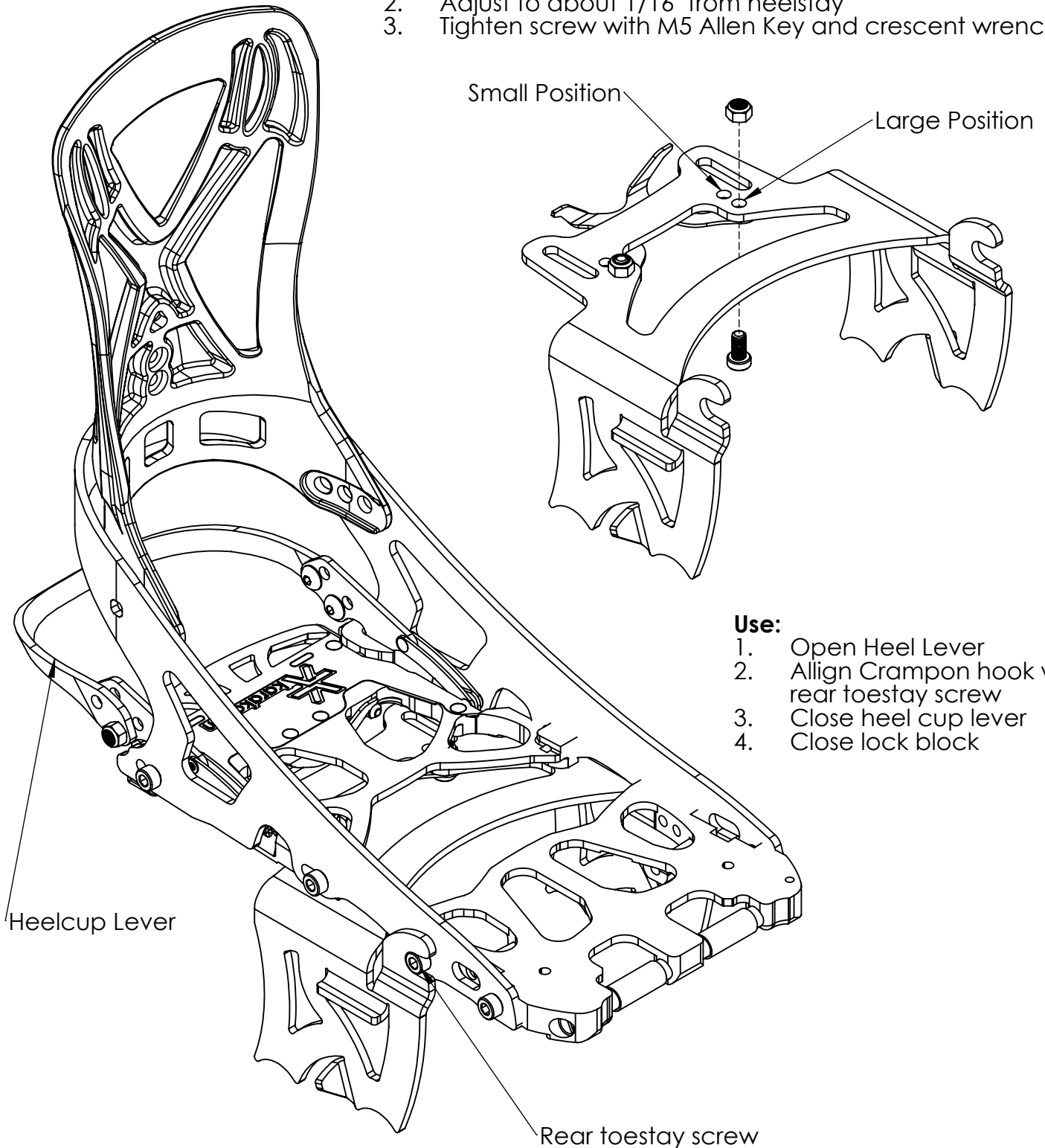

Use:

1. Open Heel Lever
2. Align Crampon hook with rear toestay screw
3. Close heel cup lever
4. Close lock block